



Project	
Date	
Prepared by	
Model #	HBX1-3005-1

HBX1-SERIES MONOPOINT HIGH BAY



OVERVIEW

The HBX1-Series is the most versatile Monopoint High Bay offered in the North American market. Built using an ultra-thin, aluminum die cast design, it is a lightweight fixture that can be configured for almost any application. From the ability to add a junction box or battery backup to integrating a remote-controlled* motion sensor or side mounting sensors and wireless adapters, the HBX1 is ready for today and the future. Offering five traditional reflector configurations and multiple mounting options, they are the only high bay you'll need to consider to meet the demands of every project.

PRODUCT HIGHLIGHTS

- Polycarbonate "Fresnel" lens for even 360° light dispersal
- AkzoNobel powdercoated aluminum driver box and housing
- Built-in surge protection
- Includes hanging hook and 10' cord
- IP65 rated
- Options available: Integrated Junction Box, Emergency Battery Backup, Motion Sensors, Reflectors, Motion Sensor Remote, and Mounting options



OPTICAL SPECIFICATIONS

Lumen Output (lm) ₁	40640 lm	Beam Angle (°) ₁	90°
CCT (K) ₁	5000K	LM80 Report (L ₇₀) Hours	>54,000 hrs
CRI (Ra) ₁	80	ISTMT Report (L ₇₀) Calculated Hours	150,000 hrs
Efficacy (lm/W) ₁	141 lm/W	Chromaticity Shift	±250K

ELECTRICAL SPECIFICATIONS

Power	300W	Current Draw at 120V _{AC} (A) ₂	2.3941A
Apparent Power (VA)	318.9VA	Current Draw at 208V _{AC} (A) ₂	1.389A
System Wattage (W)	288.17W	Current Draw at 240V _{AC} (A) ₂	1.215A
Replacement for	Up to 1000W HID	Current Draw at 277V _{AC} (A) ₂	1.0601A
Input Voltage	120-277V		

LED AND DRIVER SPECIFICATIONS

LED Type	2835	THD	15.00%
Dimmable	0-10V	Driver Class	Class 2
Output Voltage (VDC)	24-68VDC	Surge Protection	10 kV
Power Factor	0.900	Inrush Current (A)	66A

DIMENSIONS

Housing Material	Aluminum	Weight (kg/lbs)	7.43kg 16.35 lbs
Housing Color	Black	Installation Method	10' cord (pre-installed) Hook (incl.) Yoke or Pendant (optional)
Lens Material	Polycarbonate	Operation Range (°F/°C)	-40°F to 122°F/-40°C to 50°C
Dimensions (inch/mm)	Ø 16.205" x 9.273" 411.6mm x 235.5mm	Warranty	10 Years

APPROVALS AND LISTINGS

DLC Premium	PLHND0PL78AM	Wet Location Rated	Yes
UL/ETL	cULus	IP Rating	IP65
		IK Rating	IK10

CANDELA

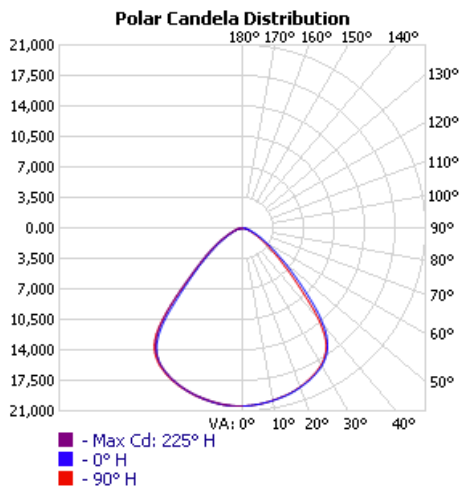

ILLUMINANCE AT A DISTANCE

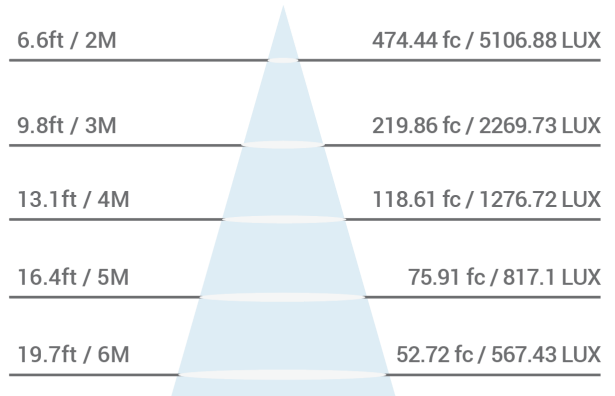

DIMENSIONS

NO REFLECTOR

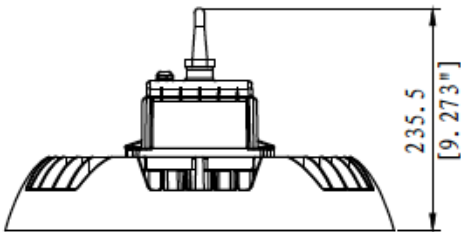

ALUMINUM REFLECTOR

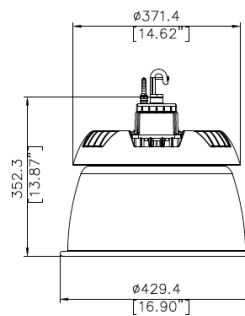

PRISMATIC REFLECTOR

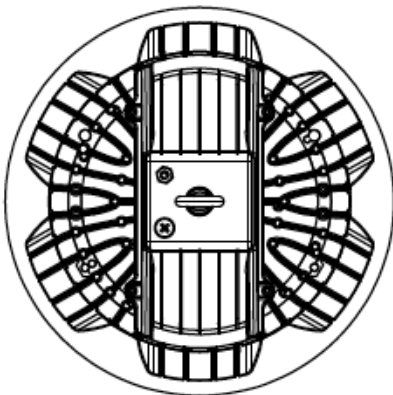
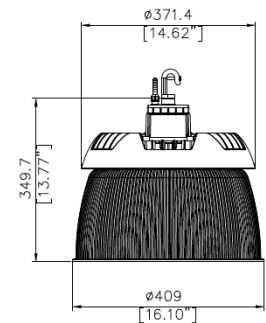

PRISMATIC REFLECTOR + DROP LENS

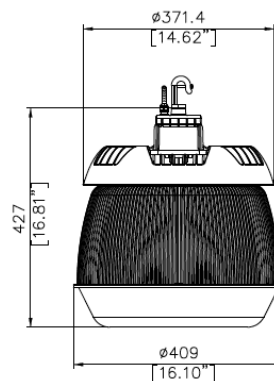

PRISMATIC REFLECTOR + CONE LENS

