

PREMISE

FPH2-SERIES Flat Panel Hybrid Fixtures



INSTRUCTIONS FOR

FPH2-1440S35-3	FPH2-2220P35-3	FPH2-2430P35-3
FPH2-1430P40-3	FPH2-2220P40-3	FPH2-2430P40-3
FPH2-1430P50-3	FPH2-2220P50-3	FPH2-2430P50-3
	FPH2-2230P35-3	FPH2-2440P35-3
	FPH2-2230P40-3	FPH2-2440P40-3
	FPH2-2230P50-3	FPH2-2440P50-3
	FPH2-2230S40-1	FPH2-2440S40-1

WHAT'S IN THE BOX

- FLAT PANEL LED FIXTURE

WHAT YOU'LL NEED (NOT INCLUDED)

- SAFETY GLASSES
- WIRE CUTTERS
- WIRING SUPPLIES AS SPECIFIED BY CODE
- AIRCRAFT CABLES OR SURFACE MOUNT KIT (IF NOT INSTALLING IN T-BAR)

IMPORTANT

Before assembling your fixture, please make sure that you carefully read through this instruction sheet.

WARNING

- Turn off electrical power at fuse or circuit breaker box before wiring fixture to the power supply.
- Turn off the power when you perform any maintenance.
- Verify that supply voltage is correct by comparing it with the luminaire label information.
- Risk of fire: minimum 90°C / 194°F supply conductors
- Modifications to the product voids the warranty.
- When dimming lower than 5% (with 3% tolerance), the synchronous dimming difference may be due to difference of wire or amount of load, which is uncontrollable.

GENERAL WIRING DIAGRAM

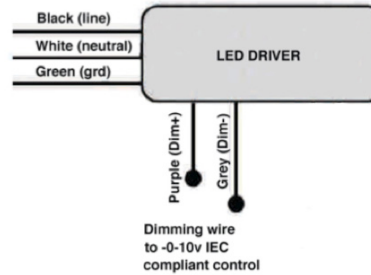

NOTE:

L= Input Line or Hot
N= Neutral

In the case of 208 or 240 line voltage, the 2nd hot leg will be connected to the white lead coming from the fixture.

TO WIRE THE DRIVER

1. Open the cover of the junction box with a screwdriver.
2. Connect the conduit to the driver box.
3. Connect the wiring. For AC input, connect the neutral wire (White) to AC-N, the live wire (Black) to AC-L and the ground wire (Green) to the grounding screw. For 0-10V dimmer wiring, connect the dimmer+ wire to the DIM+ and connect the dimmer- wire to the DIM-.
4. When wiring is complete, replace the junction box cover and tighten the screw.

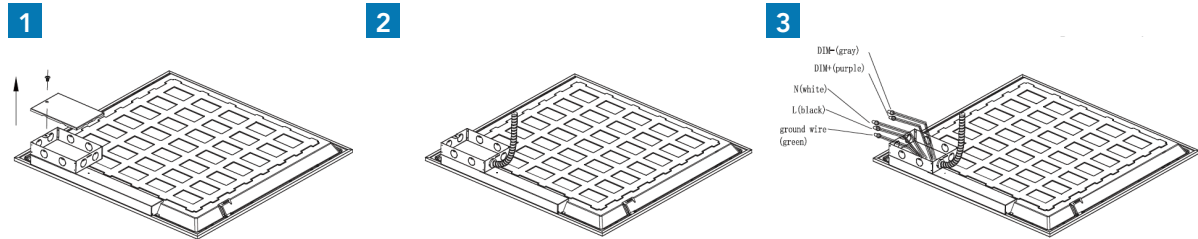

TO INSTALL INTO T-BAR CEILING

1. Remove the existing ceiling tile (or fixture you are replacing).
2. Insert the panel light into the T-bar grid (T-bar grid must adequately support the weight of the fixture).
3. Connect the power supply (refer to the Wiring Diagram).
4. Bend out the attached T-bar clips to support the fixture on the T-bar grid. Additionally, use jack chain fixed onto the structure of the roof and looped into the brackets for added safety.
5. Installation is now complete.

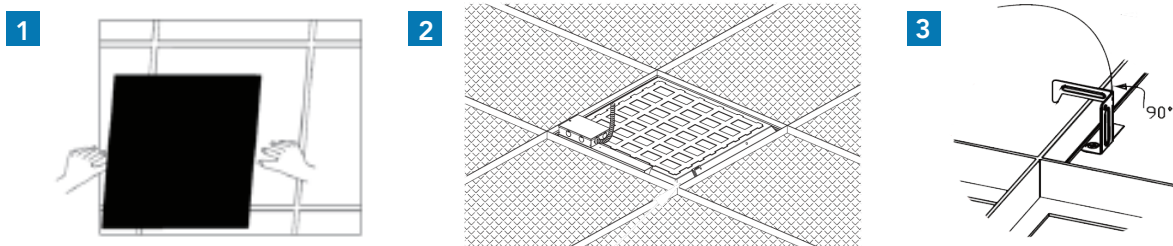

SCAN FOR MORE TIPS

