

Product Specifications

SOLAR LED FLOOD LIGHT

80W-100W-150W



BEEM2 Series 150LPW

CCT Selectable

3 YEAR Warranty

Controlled by ZeroSUN™ Technology

10 Year Warranty available

GPRS Wireless monitoring and controls available - please inquire

50,000 hrs

Powered by high performance long lasting, -40C rated Lithium Batteries

Overview

Luminous efficacy >150LPW
 Plug-and-Play - Simple Connections
 LED: Philips Lumileds 5050 - 43VDC
 Solar Panels 18 or 36V monocrystalline
 Controls Voltage 12VDC
 Operating Temperatures: -40 to +55C
 Operating Temperatures: -50 to +55C - OPTIONAL
 Power Factor >0.9

Mounting Options

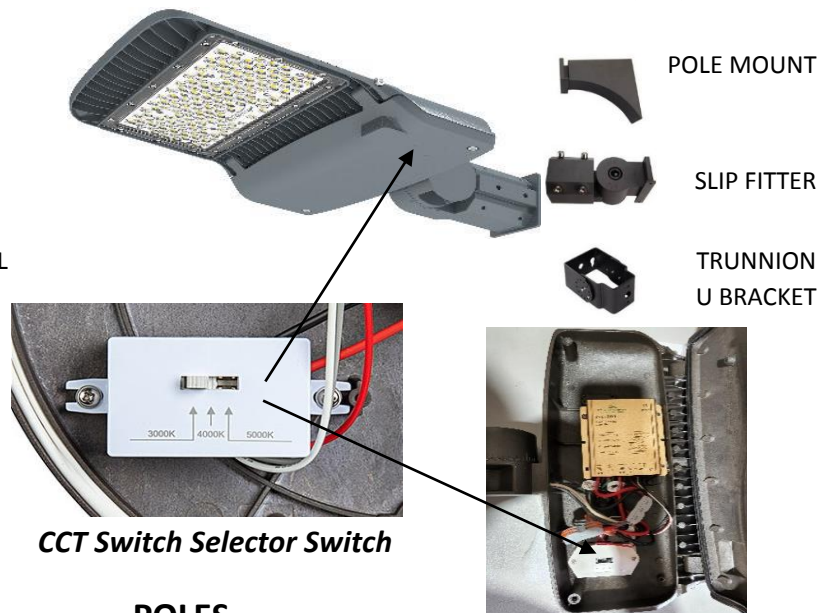

Photometric

CRI Ra>75
CCT Switch 3000 - 4000 - 500K
 Beam Angle: Type 2; 3; 5

CCT Switch Selector Switch

POLES

Models	Watts	Lm	Height	Spacing	System V	Pole Arm
029ZSM-BEEM100W	80	12000	5-6 m	20-25 m	12VDC	as per project requirements
029ZSM-BEEM100W	100	15000	5-6 m	20-25 m	12VDC	
029ZSM-BEEM150W	150	22500	6-7 m	25-30 m	24VDC	

Measurements/Weight

80/100W body 8.6x12.5x2.7" / 6.2lbs
 150W - body 13.6x13.0x2.7" / 10.3lbs

System design to follow regional requirements including battery type and panel selection



SIMPLE INSTALLATION WITH PLUG-AND-PLAY CONNECTORS

POLE TOP ASSEMBLY KIT

Designed for virtually unlimited flexibility, adjustment and easy installation

Adjustable pivoting PV panel support
Adapter for Panel Support and Light Support

Complete set of wiring and connectors provided
Custom design available



POLE MOUNTED CONTROL CABINET - including:

- Batteries** Lithium NCM or Lithium Ion, Rated at -40C
AGM/GEL 12V - optional
- Controllers** ZeroSUN™ A type - standard
ZeroSUN™ M type - for GPRS LoraVAN controls optional
- Thermal Module - optional for -50C rating



- Ingress protection IP65
- Insulated R10
- Measurements 18 x 17.5 x 16.5" H
- Loaded Weight 180 lbs approx. - based on Battery type
- Mounting Clamping hardware, Stainless Steel

mounting brkt

cable feed



DW series solar panel designs - OPTIONAL

High performance decorative panels



Product Specifications

Solar Pole System 5-6-7m - BASE MOUNT

Modular design for easy and quick installation
All components provided as required for the installation
The creative design is modular and significantly reduces the cost of installation
Simple plug-in connectors between Luminaire and PV panel
Complete set of stainless steel mounting hardware provided

Light Pole

Round tapered steel
Base plate

Arm Support

Slides over top of pole
Supports Luminaire with Slip Fitter mount
Convenient directional adjustment
4ft & 6ft Utility Arms - OPTIONAL

Spigot module & Panel Support Frame

Simple slide-on mounting on Arm
Fully adjustable to optimize panel orientation

Anchor Module

Preassembled, fits Base Plate design
Set of Rebars included

EPA RATING

Upplands warrants that the design of all components including Light Pole meets EPA requirements for all systems sold.

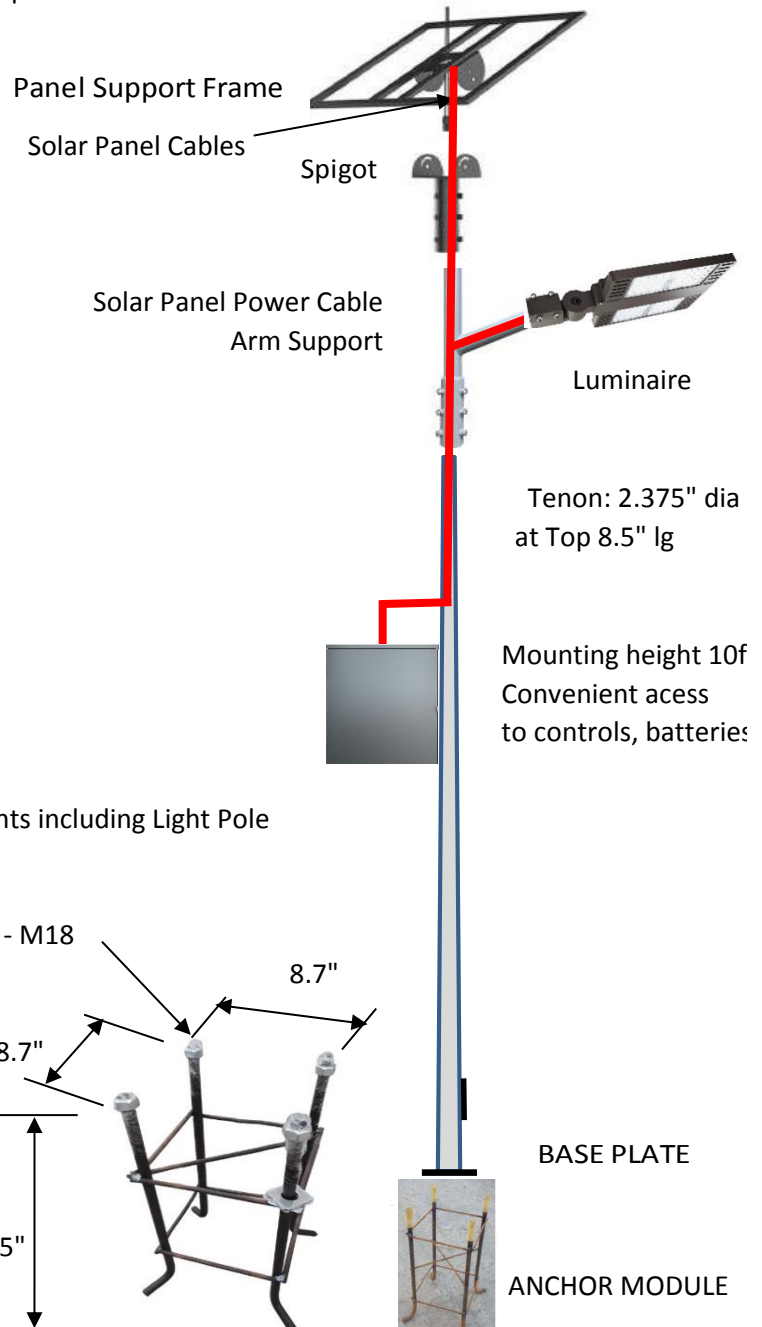

Base Plate 12"x12" 4 - M18

Note:

* Anchor dimensions may change based on pole type and load requirements

Auger Base - OPTIONAL



Benefit: Drills directly into the ground
No Concrete base

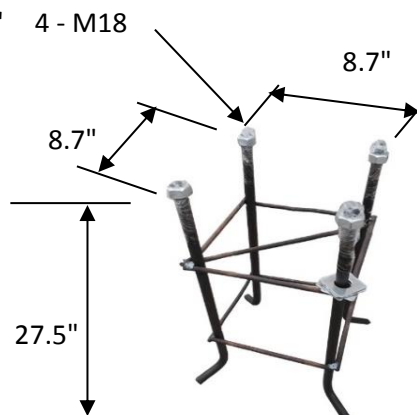

inquire info@upplandsenergy.com

